

REDUCER w/ NEMA C-Face Adapter - QV

1 inch = 25.4 mm
All dimensions listed are for reference only.
Contact factory for certified dimensions.

INCH SHAFT - SINGLE STAGE - HOLLOW QUILL INPUT

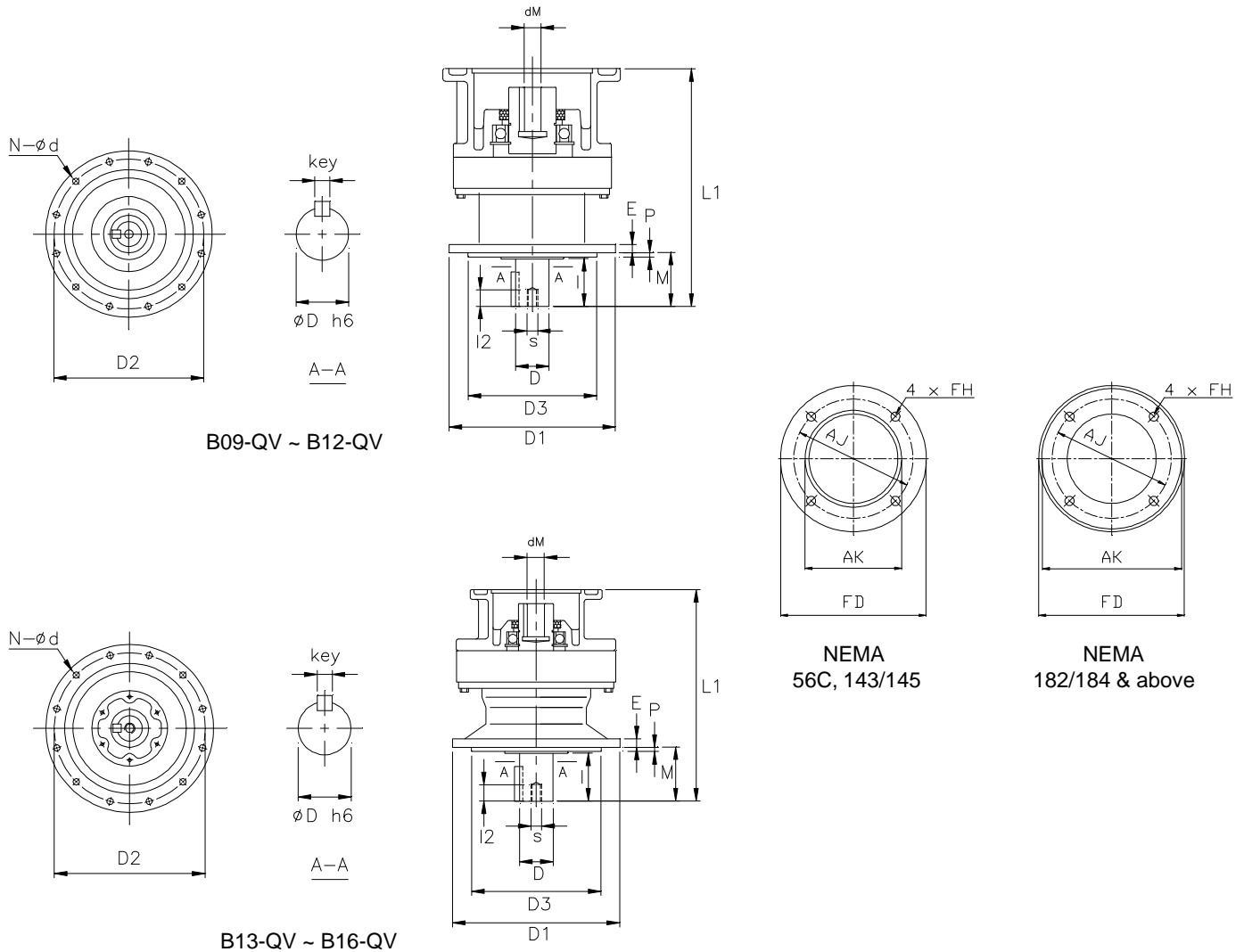

DARALI Frame	Motor Frame	Dim. in mm										Dim. in inch					Key	s	I2	Wt (lb)	
		L1	D1	D2	D3	E	M	N	d	P	NEMA C-Face Adapter										
											dM	AK	FD	AJ	FH	D					I
B09-QV	56C	241	160	134	110	9	63	4	11	3	0.625	4.500	6.625	5.875	0.433	1.125	1.97	1/4 x 1/4 x 1.18	M8	18	29
	143/145	241	160	134	110	9	63	4	11	3	0.875	4.500	6.625	5.875	0.433	1.125	1.97	1/4 x 1/4 x 1.18	M8	18	29
B10-QV	56C	247	160	134	110	9	63	4	11	3	0.625	4.500	6.625	5.875	0.433	1.125	1.97	1/4 x 1/4 x 1.18	M8	18	33
	143/145	247	160	134	110	9	63	4	11	3	0.875	4.500	6.625	5.875	0.433	1.125	1.97	1/4 x 1/4 x 1.18	M8	18	33
B11-QV	56C	264	210	180	140	13	69	6	11	4	0.625	4.500	6.625	5.875	0.433	1.500	2.17	3/8 x 3/8 x 1.77	M10	18	59
	143/145	264	210	180	140	13	69	6	11	4	0.875	4.500	6.625	5.875	0.433	1.500	2.17	3/8 x 3/8 x 1.77	M10	18	59
	182/184	278	210	180	140	13	69	6	11	4	1.125	8.500	8.875	7.250	0.433	1.500	2.17	3/8 x 3/8 x 1.77	M10	18	63
B12-QV	56C	264	210	180	140	13	69	6	11	4	0.625	4.500	6.625	5.875	0.433	1.500	2.17	3/8 x 3/8 x 1.77	M10	18	59
	143/145	264	210	180	140	13	69	6	11	4	0.875	4.500	6.625	5.875	0.433	1.500	2.17	3/8 x 3/8 x 1.77	M10	18	59
	182/184	278	210	180	140	13	69	6	11	4	1.125	8.500	8.875	7.250	0.433	1.500	2.17	3/8 x 3/8 x 1.77	M10	18	63
B13-QV	182/184	334	260	230	200	15	76	6	11	4	1.125	8.500	8.875	7.250	0.551	1.875	2.76	1/2 x 1/2 x 2.17	M10	18	108
	213/215	351	260	230	200	15	76	6	11	4	1.375	8.500	8.875	7.250	0.551	1.875	2.76	1/2 x 1/2 x 2.17	M10	18	113
B14-QV	182/184	354	260	230	200	15	96	6	11	4	1.125	8.500	8.875	7.250	0.551	1.875	3.54	1/2 x 1/2 x 2.17	M10	18	110
	213/215	371	260	230	200	15	96	6	11	4	1.375	8.500	8.875	7.250	0.551	1.875	3.54	1/2 x 1/2 x 2.17	M10	18	116
B15-QV	182/184	354	260	230	200	15	96	6	11	4	1.125	8.500	8.875	7.250	0.551	1.875	3.54	1/2 x 1/2 x 2.17	M10	18	115
	213/215	371	260	230	200	15	96	6	11	4	1.375	8.500	8.875	7.250	0.551	1.875	3.54	1/2 x 1/2 x 2.17	M10	18	121
B16-QV	182/184	405	340	310	270	20	89	6	11	4	1.125	8.500	8.875	7.250	0.551	2.250	3.54	1/2 x 1/2 x 2.95	M10	18	228
	213/215	421	340	310	270	20	89	6	11	4	1.375	8.500	8.875	7.250	0.551	2.250	3.54	1/2 x 1/2 x 2.95	M10	18	234